

Diecutting, perforating, and scoring in-line on your sheet fed offset printing press. No press modification is necessary and our experienced technicians familiarize your staff with the 30-45 minute set-up process. The RSP system is perfect for pocket folders, L-perforations, door hangers, and slitting at full press running speeds. Eliminate a manufacturing step and increase profits on every printing job. Repeat jobs can be saved with the printing plates for reruns.

## RSP System

Transforms your printing press into an in-line finishing system easily and cost effectively.

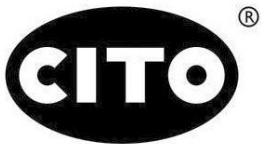

### Heidelberg Machine Model

GTO46

GTO52

SM52

SM52 L Coater

MO / SORK

SO74 / SORM / SM72

SM74 / PM74 Standard

SM74 / PM74 Thin U-Bar

SM74 / PM74 L Coater

CD 74 / XL 75

### Heidelberg Machine Model

CD 74 Coater / XL 75 Coater

SORD

SM 102 / SORS Standard

SM 102 / SORS Thin U-Bar

CD102 Standard

CD102 Thin U-Bar

SM/CD 102 L Coater

XL105 U-Bar

XL105 L U-Bar Coater

### Komori Machine Model

Lithrone 20

Lithrone 26

Sprint 26

Lithrone 28

Sprint 28

Lithrone 40

Lithrone 40 Thin U-Bar

Lithrone LS 40

### New RSP Base System contents and packaging!

- 1 RSP Base Plate
- 1 RSP Mylar Grid
- 4 Protective Impression Cylinder Jackets
- 1 RSP Perforating Rule
- 1 RSP Supporting Foam
- 1 Hexagon Socket Wrench
- 1 Side Cutter
- 1 RSP Adhesive Tape
- 1 RSP Video

Note: \*On-site training offered for additional price.

# RSP EASY



Every commercial printer is required to deliver every job faster, cheaper and all with shorter run lengths. The new RSP Easy Set is the perfect tool allowing you to finish jobs in-line. Perforating, scoring, and diecutting is now completed in-line at full press running speeds.

## RSP Easy Set

Easy in-line finishing on printing presses.



Press Model
Heidelberg CD102 coating
Heidelberg CD102 printing
Heidelberg CD74 printing
Heidelberg GTO52 printing
Heidelberg MO printing
Heidelberg SM102 coating
Heidelberg SM102 printing
Heidelberg SM52 printing
Heidelberg SM72 printing
Heidelberg SM74 coating
Heidelberg SM74 printing
Heidelberg SO74 printing
Heidelberg SORD printing
Heidelberg SORM printing
Heidelberg XL105 printing
Heidelberg XL75 printing

Press Model
KBA Rapida 74 printing
KBA Rapida 75 printing
KBA Rapida 75 coating
KBA Rapida 105 printing
KBA Rapida 105 coating
KBA Rapida 106 printing
KBA Rapida 106 coating
Komori Lithrone 40 coating
Komori Spica 29 printing
Komori Lithrone S29
Manroland 300 printing
Manroland 700 printing
Ryobi 520 coating
Ryobi 520 printing
Ryobi 750 printing

### Basic RSP Easy Set contains:

- 2 Base Blankets with millimeter scale
- 2 Protective Impression Cylinder Jackets
- 2 Protective Impression Cylinder Jackets in strips
- 1 RSP Adhesive Tape
- 2 Rolls Make-ready Tape
- 1 Tube RSP Supporting Foam
- 1 Box RSP Perforating Rule
- 1 Operators Manual
- 1 Side Cutter
- 1 Pair Safety Gloves
- 1 Storage Case

### Advantages and Features of the New RSP Easy Set System

- Low initial cost
- Easy mounting and removal
- Perforating, scoring and die cutting in-line
- Developed in conjunction with Heidelberg

### Individual Base Blanket Prices

Base Blanket - Small Format 20" Press	\$300.00
Base Blanket - Medium Format 29" Press	\$350.00
Base Blanket -Large Format 40" Press	\$400.00

# RSP CONSUMABLES

PrintLine



MYLAR GRID

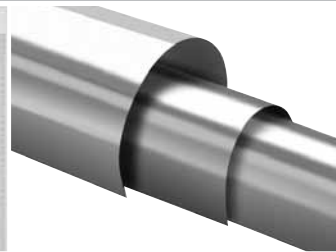

CYLINDER JACKET



PROCESSING RULES

## RSP PROTECTIVE IMPRESSION CYLINDER JACKETS AND STRIPS

Self-adhesive; for the protection of the impression cylinder during the cutting and perforating process.

### Quantity Discounts Consumable Supplies

Combination of any accessory items

5 to 10 items	less 2%
11 to 20 items	less 4%
21 to 30 items	less 6%
31+ items	less 8%

Part #	Printing Press	Dimensions
ICJGTO46	Heidelberg GTO 46	452 x 312 mm
ICJGTO52	Heidelberg GTO 52	513 x 343 mm
ICJGTO52P	Heidelberg GTO 52	513 x 343 mm
ICJSM52	Heidelberg SM 52	526 x 363 mm
ICJSM52P	Heidelberg SM 52	526 x 363 mm
ICJMO1	Heidelberg MO	650 x 474 mm
ICJMO1P	Heidelberg MO	650 x 474 mm
ICJSO741	Heidelberg SO74/SORM/SM72	726 x 513 mm
ICJSO741P	Heidelberg SO74/SORM/SM72	726 x 513 mm
ICJSORD	Heidelberg SORD	623 x 448 mm
ICJSM742	Heidelberg SM74/PM74	373 x 513 mm
ICJSM741	Heidelberg SM74/PM74	746 x 513 mm
ICJSM741P	Heidelberg SM74/PM74	746 x 513 mm
ICJSM/SO/CD1022	Heidelberg SM/SORS/CD 102	513 x 703 mm
ICJSM/ SO/CD1022P	Heidelberg SM/SORS/CD 102	513 x 703 mm
ICJSM102 Full	Heidelberg SM/SORS/CD 102	703 x 1026 mm
ICJSM102P Full	Heidelberg SM/SORS/CD 102	703 x 1026 mm
ICJCD74 (74L)	Heidelberg CD74 / CD74L / XL75	373 x 610 mm
ICJCD74/XL75 Full	Heidelberg CD74 / CD74L / XL75	746 x 610 mm
ICJCD74/XL75P Full	Heidelberg CD74 / CD74L / XL75	746 x 610 mm
ICJXL105	Heidelberg XL105	743 x 528 mm
ICJXL105 Full	Heidelberg XL105	1056 x 743 mm
ICJKL20	Komori Lithrone 20	526 x 362 mm
ICJKL26	Komori Lithrone 26	470 x 665 mm
ICJKS26	Komori Sprint 26	470 x 665 mm
ICJKL28	Komori Lithrone 28	726 x 513 mm
ICJKS28	Komori Sprint 28	726 x 513 mm
ICJKL402	Komori Lithrone 40	513 x 703 mm
ICJR700	Roland 700	732 x 522 mm
ICJ Strips	20" Press	513 x 65 mm
ICJ Strips	28" Press	706 x 65 mm
ICJ Strips	40" Press	1050 x 65 mm

Part numbers which end in P are for Perfecting Machines. Part numbers which end in 2 are half size jackets. This price is for purchasing in quantities of 10. If less than 10 purchased a 15% handling charge will be added.

# RSP CONSUMABLES

## RSP MYLAR GRIDS

Adjusted to the individual cylinder diameter for pre-makeready of the RSP form outside the press.

Part#	Printing Press
MGGTO46	Heidelberg GTO 46
MGGTO52	Heidelberg GTO 52
MGSM52	Heidelberg SM 52
MGSM52L	Heidelberg SM 52 Coater
MGMO	Heidelberg MO/SORK
MGSO74	Heidelberg SO 74/SORM/SM72
MGSM74	Heidelberg SM74/PM74
MGSM74L	Heidelberg SM74/PM74 Coater
MGCD74	Heidelberg CD 74 / XL 75
MGCD74L	Heidelberg CD 74 / XL 75 Coater
MGSORD	Heidelberg SORD
MGSM/ SO102	Heidelberg SM/SORS 102
MGCD102	Heidelberg CD 102

Part#	Printing Press
MGXL105U	Heidelberg XL105
MGXL105L	Heidelberg XL105 Coater
MGKL20	Komori Lithrone 20
MGKL26	Komori Lithrone 26
MGKS26	Komori Sprint 26
MGKL28	Komori Lithrone 28
MGKS28	Komori Sprint 28
MGKL40	Komori Lithrone 40
MGKL40U	Komori Lithrone 40
MGR700	Roland 700

## RSP OFFSET CREASING STRIPS STANDARD "ORS"

For scoring in letterpress quality. Various dimensions for different paper/board qualities.

Part#	Dimension	Unit
ORS0208	0.2 x 0.8 mm	30 pcs
ORS0210	0.2 x 1.0 mm	30 pcs
ORS0307	0.3 x 0.7 mm	30 pcs
ORS0308	0.3 x 0.8 mm	30 pcs
ORS0310	0.3 x 1.0 mm	30 pcs
ORS0311	0.3 x 1.1 mm	30 pcs
ORS0312	0.3 x 1.2 mm	30 pcs
ORS0313	0.3 x 1.3 mm	30 pcs

## RSP OFFSET CREASING STRIPS OFF-CENTER "OCC"

Part#	Dimension	Unit
OCC0310	0.3 x 1.0 mm	30 pcs
OCC0312	0.3 x 1.2 mm	30 pcs
OCC0313	0.3 x 1.3 mm	30 pcs

## RSP PROCESSING RULES

For scoring, cutting and perforating; height-adjusted and designed for the RSP In-line Finishing System.

Part#	Dimension	Unit
PRPerf08	Perf 8 tpi	20 feet
PRPerf12	Perf 12 tpi	20 feet
PRPerf16	Perf 16 tpi	20 feet
PRPerf35	Perf 35 tpi	20 feet

Part#	Dimension	Unit
PRPerf50	Perf 50 tpi	20 feet
PRCut	Cut	20 feet
PRCreaseR1	Crease R1	20 feet
PRCreaseR2	Crease R2	20 feet

## RSP SUPPORTING FOAM

Applicable in the trim area in order to ensure the flatness of the printed sheet.

Part#	Description	Dimension	Unit
SF	RSP Supporting Foam OSF	1/4" x 27.5'	50 pcs

## RSP ADHESIVE TAPES

For securing the etched dies on the RSP mylar grid.

Part#	Description	Unit
MK5	Adhesive Tape Flexible Cutting Dies	20 - 1/2" x 32.8'
SK	Protective Adhesive Tape	1/2" x 55'

## RSP TOOLS

Part#	Description	Unit
PRC	Side Cutter	1 piece
Socket Wrench	Hexagon Socket Torque Wrench	1 piece
ICJ Removal Aid	Removal Aid for Protective Jackets	1 piece

## CITO STEEL SHIM TAPE

Part #	Thickness	Dimension
ShimTape 0.03	.03mm (.001")	10m (32.8') x 6.5 mm (1/4")
ShimTape 0.04	.04mm (.0015")	10m (32.8') x 6.5 mm (1/4")
ShimTape 0.05	.05mm (.002")	10m (32.8') x 6.5 mm (1/4")
ShimTape 0.10	.10mm (.004")	10m (32.8') x 6.5 mm (1/4")

## SPEED PERF

High quality perforating rule for offset presses.

Part #	Description	Unit
T-301	Center Score	20 feet
T-501	Side Score	20 feet
T-505	Side Perf - 16 TPI	20 feet
T-507	Side Perf - 12 TPI	20 feet

## PRESS GAUGES

Part #	Description
DigiNip	Digital Roller Nip and Setting Gauge
PosiTector FTS-1	Digital On Press Blanket, Packing and Plate Thickness Gauge for non-metal Surfaces
PosiTector FNTS-1	Digital On Press Blanket, Packing and Plate Thickness Gauge, for any Surface, including Metal

# PRINT GUARD

## PRINT GUARD PLUS

Anti-marking jackets and film for transfer cylinders.

Part#	Printing Press
PG SM102 R-L	Heidelberg SM102 Post 1994/5 Transfer Cylinder
PG SM102 RPM	Heidelberg SM102 Post 1994/5 Perfecting Cylinder
PG SM102 L-L	Heidelberg SM102 Pre 1994 Transfer Cylinder
PG SM102P MAG	Heidelberg SM102 Pre 1994 Perfecting Cylinder (MAG.)
*PG SM102D 705	Heidelberg SM102 Delivery Cylinder
*PG SM102D 756	Heidelberg SM102 Delivery Cylinder
*PG SM102D 762	Heidelberg SM102 Delivery Cylinder
PG SM102 BB 845	Heidelberg SM102 Coater Blanket Cylinder
PG SM74T	Heidelberg SM74 Transfer Cylinder
PG SM74D	Heidelberg SM74 Delivery Cylinder
PG SM72T	Heidelberg SM72 Transfer Cylinder
PG MO26T561	Heidelberg MO26 Transfer Cylinder
PG SM52T	Heidelberg SM52 Transfer Cylinder
PG SM52D	Heidelberg SM52 Delivery Cylinder
PG GTO52T413	Heidelberg GTO52 Transfer Cylinder (No Perfector)
*PG GTO52T418	Heidelberg GTO52 Transfer Cylinder For Perfecting Press
*PG GTO52T423	Heidelberg GTO52 Transfer Cylinder For Perfecting Press
PG GTO52P	Heidelberg GTO52 Perfecting Cylinder
PG QM 46V	Heidelberg QM46 Transfer Cylinder
PG MIT3000 BB759	Mitsubishi Diamond 3000 Perfecting Cylinder

\*Remove Existing Transfer or Delivery Cylinder Jacket. Lay Flat and Measure From End to End in Millimeters.

T - Transfer Cylinder

TP - Transfer Cylinder on Perfecting Presses

P - Perfecting Cylinder

RL - Rivet To Loop

LL - Loop To Loop

D - Delivery Cylinder

## ORANGE HIDE SILICONE SHEETS

Press Model	Cylinder Circum.	Cylinder Length	Sqft
Komori Lithrone 20	14.75"	28.75"	2.94
Komori Lithrone 26	20.75"	27.00"	3.89
Komori Lithrone 28	20.75"	28.75"	4.14
Komori Lithrone 40	28.50"	41.00"	8.11
Komori Lithrone 44	33.25"	44.50"	12.82

## ECONOMY JACKETS

Part#	Printing Press
SM102RL-E	Heidelberg SM102
SM102LL-E	Heidelberg SM102
SM102D705-E	Heidelberg SM102
SM102D756-E	Heidelberg SM102
SM102D762-E	Heidelberg SM102
SM74T-E	Heidelberg SM74
SM74D-E	Heidelberg SM74
SM72T645-E	Heidelberg SM72
MO26T570-E	Heidelberg MO26
MO26T565-E	Heidelberg MO26
MO26T561-E	Heidelberg MO26
MO26T555-E	Heidelberg MO26
MO26T552-E	Heidelberg MO26
SM52T-E	Heidelberg SM52
SM52D-E	Heidelberg SM52
GTO52T413-E	Heidelberg GTO52
GTO52TP418-E	Heidelberg GTO52
GTO52TP423-E	Heidelberg GTO52
GTO52TP425-E	Heidelberg GTO52
QM-46V-E	Heidelberg QM46

PGE Jackets have woven fabric backing, 1/3 Orange Hide coating, standard fixtures.